

Dormitory ITABASHI-EKIMAE

1 minute walk from Itabashi sta.
2 minutes to Ikebukuro sta. by train

- 16 minute walk to Meros, 5 minute by bicycle
- 1 minute walk to the nearest convenience store.

7-6-6 Takinogawa, Kita-ku Tokyo



Pictures



Cost

Initial cost (6 months contract)

Single	Rent	: (37,000 ~ 49,000) yen × 6 months
	Common service charge	: 10,000 yen × 6 months
	Occupancy costs	: 50,000 yen
	Deposit	: 30,000 yen
	Cleaning costs after leaving	: 10,000 yen
	New bedding	: 10,000 yen

合計：382,000～454,000 yen

(Common service charge includes: electricity, water, gas, WiFi)

Equipment

Communal area

Microwave	●	Electricity	●
IH electric cooker	●	Washing machine	●
Refrigerator	●	Drying machine	
Rice Cooker	●	Toilet	●
Tableware		Shower Room	●
Gas	●	High-speed wireless Internet	●
Water	●		

Each room

Bed	●
Desk	●
Chair	●
Bookshelf	
Air conditioner	●

(Washing machine use: 100 yen / 1 times)

Floor map

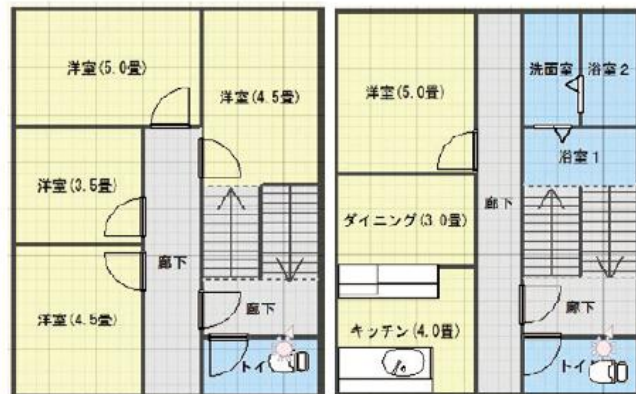

2F

3F

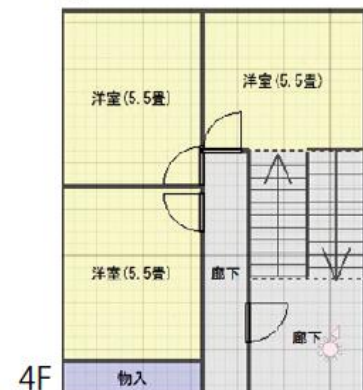

4F